

# Low Frequency Ferrite Clamp RFCW Series

**NEW**  
**Patent Pending**



Ferrite clamp that can withstand engine compartment conditions

- Wide operating temperature range: -40°C~125°C
- On-board vibration requirement: ISO-16750-3- II compliant for passenger vehicle gear shifts
- Conducted noise suppression filter for applications up to 125°C and 10G vibration
- Locking mechanism on plastic casing ensures secure fit; tool required to uninstall
- RFCW-C10 has a bracket for temporary fixation to corrugated tubes
- Clamp feet designed for tape mounting
- Plastic casing features strap guides to prevent ferrite from sliding along the cable
- Plastic casing: UL94V-2 rating



## Specification

Unit:mm

Part Number	A	B	C	D	Applicable cable diameter	Impedance Ω/100MHz (1 turn)
RFCW-C10-A-BK	34.6	36.8	35.0	58.7	φ10 Corrugated tube	≥140
RFCW-13MA-BK	31.4	33.6	34.8	58.3	φ13.5 MAX	≥ 20Ω (10MHz (1 turn))

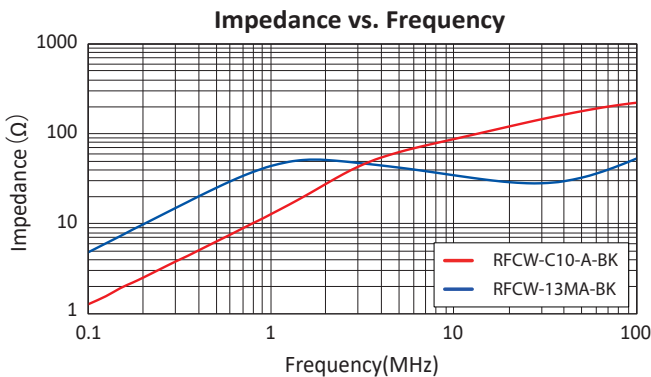
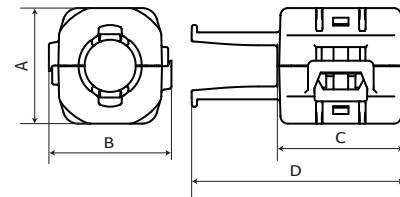

## Design features

### Easy to install and secure

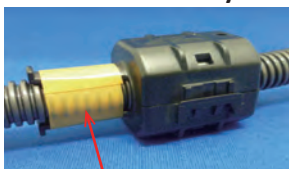

Clamp feet designed for tape mounting



Plastic strap guide prevents sliding

### Embedded metal spring

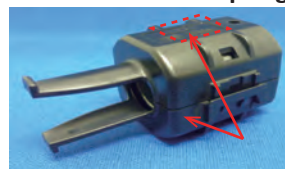

Withstands high temperature and vibration

### Easy to uninstall



Slot for flat head screw driver to lock / unlock for installation and removal

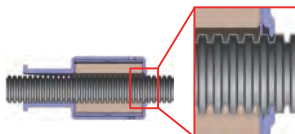

\* RFCW-C10-A-BK

The bracket fixture allows temporary fixation on tube corrugations.



\* This product is in 1 set of configurations in two identical parts.

### Please request for detailed product specification data prior to purchase

Volume resistivity stated on our EMI absorber flyer is meant for noise control parameters, where the absorber is considered a conductor, but not for insulation performance. Care should be taken when using absorbers. KITAGAWA INDUSTRIES America, Inc. makes no guarantees as to electrical resistivity values and accepts no liability due to short circuits where EMI absorbers are used directly on a PC Board or areas near high voltage such as for power. The products are designed for EMI noise reduction for electronics. This is not recommended for applications involving human life or extremely high accuracy. Prior to using the products in production, please verify their performance or adhesive strength of PSA for long term use. Avoid applying any external stress such as bending or high amounts of tension. Note when the absorber products are cut, bent, or pulled, there may be a possibility of creating cracks. For storage, keep products in a cool, dry, well-ventilated area at room temperature and avoid high temperatures, humidity, and direct sunlight.

Please contact the sales department at KITAGAWA INDUSTRIES America, Inc. for the use of our products prior to selecting the parts for your application.